

Introduction

This sheet will guide you through the basic steps needed to install the 2-Port KVM Switch (the Switch). If you have any problems during installation, please refer to the User Manual.

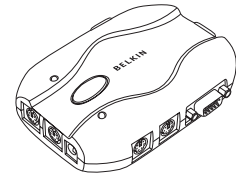

You will need the following items to install the 2-Port KVM Switch:

- KVM Switch
- One (each) keyboard, monitor, and mouse
- One KVM cable kit per computer installed (included)

Recommended Cable Kit:

F1D9000-XX PS/2 Style
(-XX denotes the length in 6, 10, 15, and 25 feet)

1

Connecting the Keyboard, Video, and Mouse to the Console Ports on the Switch

1. Power down all computers.
2. Connect your PS/2-type keyboard and mouse to the KEYBOARD and MOUSE ports located on the side panels of your Switch.

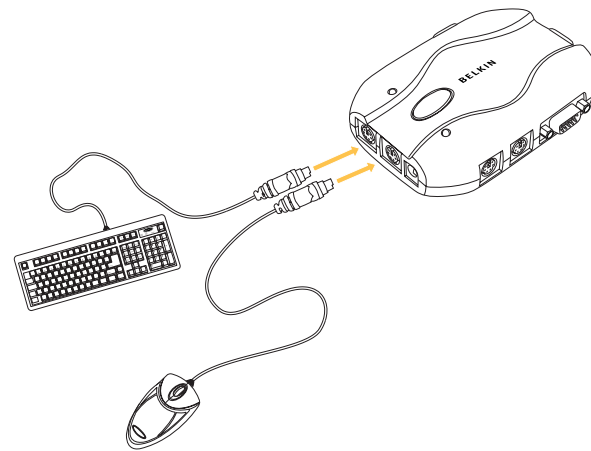

3. Take the video cable that is attached to your monitor and connect it to the VGA OUT port located on the side of the Switch.

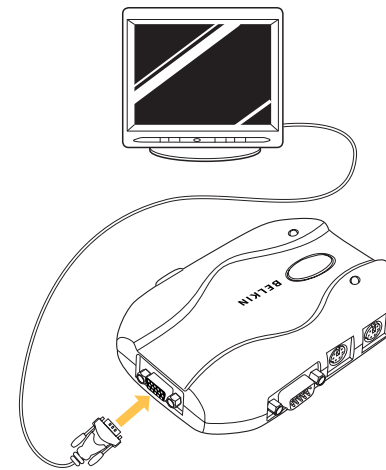

2

Connecting Computers to the Switch

1. Using an OmniView KVM Cable kit, take the VGA cable and connect the male end of the cable to the VGA port on the first computer. Connect the female end to the VGA 1 port on the side of the Switch.

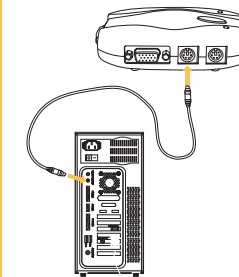
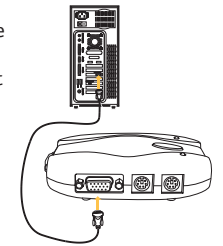

2. Connect one end of the PS/2 keyboard KVM cable to the keyboard port on the computer and the other end to the KEYBOARD 1 port on the side of the Switch.

2

Connecting Computers to the KVM Switch

3. Connect one end of the PS/2 mouse KVM cable to the mouse port on your computer and the other end to the MOUSE 1 port on the side of the Switch.

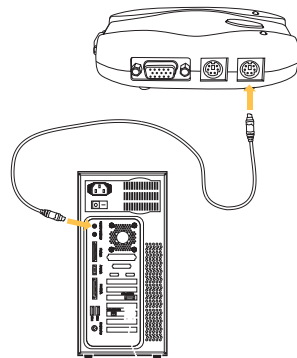

Repeat Steps 1 through 3 for each additional computer to be connected to the Switch, connecting them to the corresponding CPU ports on the side.

3

Power on your Computers

You are now ready to use your Switch.
Please refer to your User Manual for additional information.

BELKIN

belkin.com

Belkin Corporation
501 West Walnut Street
Compton • CA • 90220 • USA
Tel: 310.898.1100
Fax: 310.898.1111

Belkin Components, Ltd.
Express Business Park • Shipton Way • Rushden
NN10 6GL • United Kingdom
Tel: +44 (0) 1933 35 2000
Fax: +44 (0) 1933 31 2000

Belkin Components B.V.
Starparc Building • Boeing Avenue 333
1119 PH Schiphol-Rijk • The Netherlands
Tel: +31 (0) 20 654 7300
Fax: +31 (0) 20 654 7349

Belkin Components, Ltd.
7 Bowen Crescent • West Gosford
NSW 2250 • Australia
Tel: +61 (0) 2 4372 8600
Fax: +61 (0) 2 4372 8603

Belkin Tech Support
US: 310.898.1100 ext. 2263
800.223.5546 ext. 2263
Europe: 00 800 223 55 460
Australia: 1800 666 040
P74226

© 2003 Belkin Corporation. All rights reserved. All trade names are registered trademarks of respective manufacturers listed.

BELKIN

2-Port KVM Switch

*Control two computers using one video monitor,
and a PS/2 keyboard and mouse*



Quick Installation Guide

F1DJ102P-B